

min 150 kg
max 5.000 kg

M 68
IP

APPLICATIONS

4 load cells platforms.
Reactors, tanks and hopper weighing.

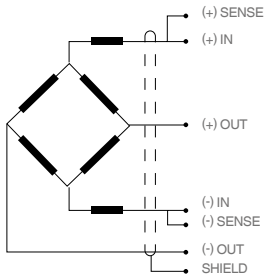

Connections	4-WIRES	6-WIRES
+IN	red	red
-IN	black	black
+OUT	green	green
-OUT	white	white
+SENSE	---	blue
-SENSE	---	yellow
Shield	purple	



FEATURES

Shear beam load cells

Versions:

G3S (0,15t): fully alloy steel construction. Sealed with silicone IP68

G3S (0,30t - 5t) fully alloy steel construction. Hermetically sealed completely welded IP68
3000 divisions OIML R60 class C.

Pre-corner adjustment optimized for multicell systems

SPECIFICATIONS

Nominal capacities (Ln)	150-300-750-1500-2000-2500-3000-5000 kg
Accuracy class	3000 n. OIML
Minimum dead load	0 %Ln
Service load	150 %Ln
Safe load limit	200 %Ln
Temperature compensation	-10±40 °C
Temperature limits	-20±70 °C
Nominal sensitivity (Sn)	3 mV/V (3)
Nominal input voltage	10 12 V
Maximum input voltage	15 V
Input impedance	400±20 Ω
Output resistance	352±3 Ω
Insulation resistance	> 5000 MΩ

LOAD CELLS G3S 150-2500 kg

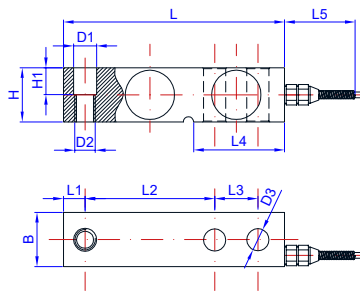

LOAD CELLS G3IS 3000 -5000 kg

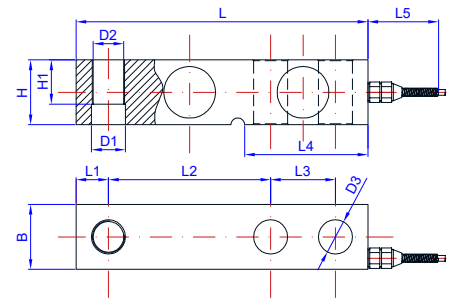

Dimensions (mm)

Emax mm	L	L1	L2	L3	L4	L5	H / B	H1	D1	D2	D3
1.0t-2.5t	130	12,7	76,2	25,4	53,5	42	31,8	20	Ø13	M12	Ø13
3.0t-5.0t	171,5	19	95,3	38,1	72,5	42	38,1	26	Ø20	M18x1,5	Ø20

CODE G3S

Reference	N. capacity - In (kg)	Accuracy class n. OIML	y = emax / vmin	Code #
G3S-150	150	C3	10000	230056
G3S-300	300	C3	10000	230057
G3S-750	750	C3	10000	230058
G3S-1500	1500	C3	10000	230059
G3S-2000	2000	C3	10000	230060
G3S-2500	2500	C3	10000	230062
G3S-3000	3000	C3	10000	230064
G3S-5000	5000	C3	10000	230066

Fully alloy steel construction, hermetically sealed welded IP68